

ENTRY AND EXIT POINTS FOR

Y6 – MISS EDDOWES Y5 – MRS ALEXANDER Y4/5 – MRS BRUGMANS

PARENTS TO ENTER SCHOOL SITE ON THE RIGHT-HAND SIDE OF DOUBLE GATES.

PARENT TO DROP CHILD OFF AT THE SCHOOL MAIN ENTRANCE DOOR.

ONCE YOU HAVE DROPPED YOUR CHILD OFF, FOLLOW THE ARROWS MARKED ON THE FLOOR AND EXIT VIA THE DOUBLE GATES – PLEASE BE AWARE OF TRAFFIC.

PLEASE FOLLOW THE SAME PROCEDURE ON COLLECTING YOUR CHILD - THE TEACHER WILL SEND YOUR CHILD OUT WHEN YOU ARRIVE AT SCHOOL. (YEAR 6 CHILDREN WILL LEAVE INDEPENDENTLY VIA THEIR CLASSROOM FIRE DOOR)

PLEASE REMEMBER

TO SOCIAL DISTANCE WHILE WAITING TO DROP OFF/PICK UP YOUR CHILD

WEAR A MASK WHEN ENTERING OUR SCHOOL GROUNDS

IF BRINGING YOUR CHILD TO SCHOOL BY CAR WAIT IN THE CAR UNTIL IT IS YOUR ALLOTTED TIME TO DROP OFF/PICK UP

IF YOU HAVE ANY QUESTIONS PLEASE DO NOT HESITATE TO CONTACT SCHOOL – TEL: 01609 773524 OR EMAIL

admin@alverton.n-yorks.sch.uk

KS2 SITE INFORMATION FOR MISS EDDOWES, MRS ALEXANDER AND MRS BRUGMANS CLASSES

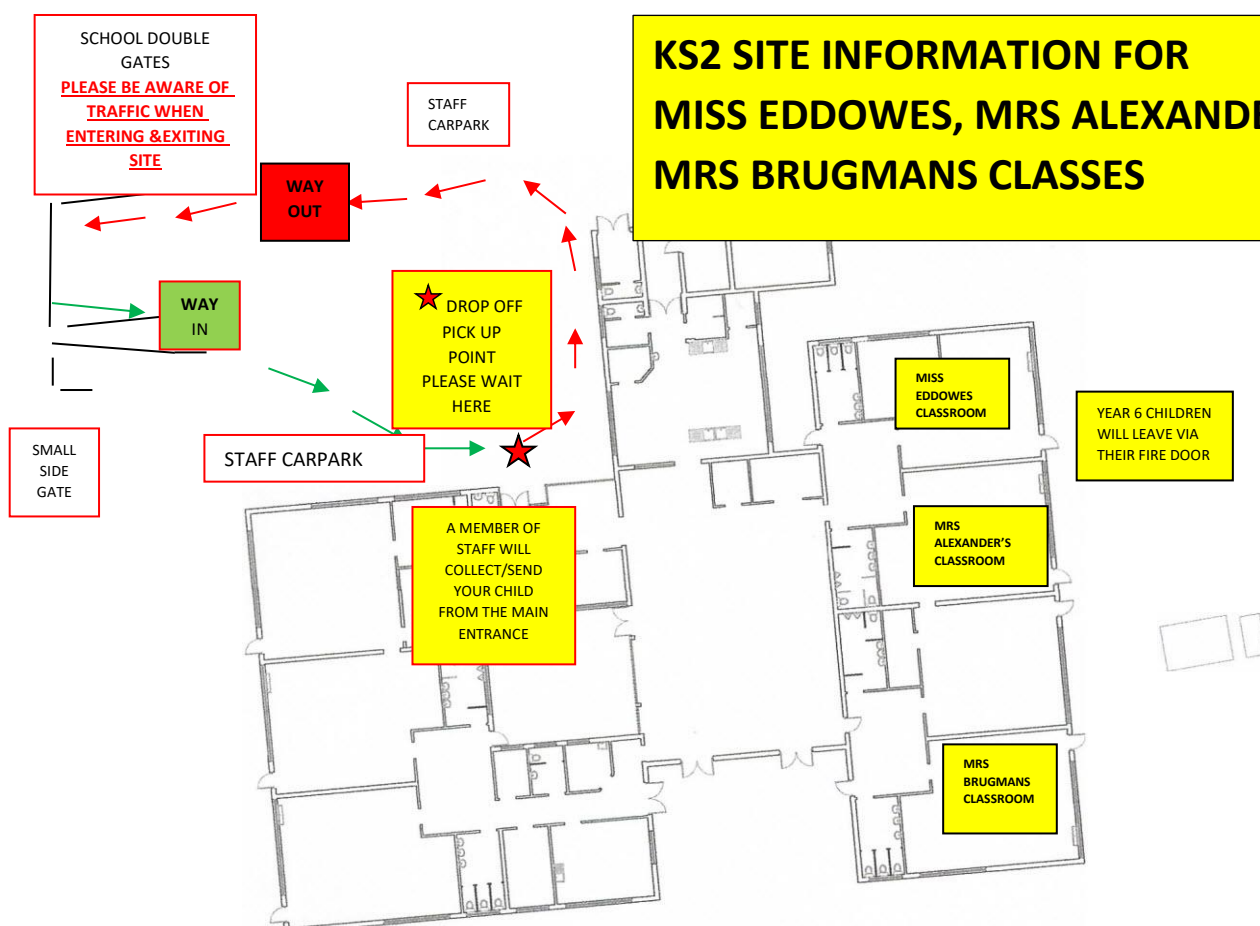

TO ENSURE THE SAFETY OF PARENTS/STAFF AND CHILDREN PLEASE DO NOT BRING YOUR CAR INTO THE SCHOOL CAR PARK OR USE THE MAIN ENTRANCE TO SCHOOL AS A DROP OFF OR TURN ROUND POINT.
THE CAR PARK IS FOR STAFF USE ONLY

Y6 Miss Eddowes
Drop off/Arrive 8:40 – 8:45
Pick up – Y6 will leave independently

Y5 Mrs Alexander
Y4/5 Mrs Brugmans
Drop off 8:40 – 8:45
Pick up 3:10 – 3:15

